



WELCOME
— to —
NEW PROVIDENCE

NEW PROVIDENCE

— NEW JERSEY —

WELCOME TO NEW PROVIDENCE!

We are very pleased to extend a warm welcome to you from the Borough of New Providence. We are a vibrant community comprised of caring citizens, excellent schools and superb shopping and dining establishments.

We hope you'll use this booklet to discover all that New Providence has to offer. Take a stroll through town and try our wonderful restaurants and explore the various shops and services—our merchants are friendly and eager to please! You can also find out about classes and recreational activities through our Community Activities Department. Learn more about our town and sign up to receive updates and information through our borough website at www.newprov.us.

We are always eager to hear how we can serve you better. Please feel free to stop by the Municipal Center and let us know if there is anything we can do to make your experience in New Providence better.

Table of Contents

Overview.....	1
History of New Providence	2
Government	3
Local Government	3
Federal, State, and County Representation.....	4
Demographics.....	5
Residential & Business Communities	7
Residential Community	7
Business Community	8
Recreation	9
Education	11
New Providence Memorial Library.....	13
Transportation	14
Directory of Borough Services.....	15
Helpful Information.....	20
Utility Companies.....	20
Automobile Registration	20
Voter Registration.....	20
Schools.....	21
Library	21
Senior Center.....	21
Fire Department.....	21
Rescue Squad.....	21
Tax Information	22
Hospitals.....	22
Public Transportation	23
New Providence Houses Of Worship	24
Borough Map and Street Directory	25

Overview

Nestled in the Watchung Mountains, New Providence is home to 13,650 residents within 3.6 square miles in northwestern Union County. Known for our beautiful residential neighborhoods, excellent school system, and wonderful businesses. New Providence is a combination of the new and the old, where contemporary living is seasoned by a heritage from earlier days. Here modern buildings coexist with vintage dwellings from colonial and Victorian times to form an architectural collage.



New Providence is conveniently located roughly 15 miles west of Newark and approximately 28 miles west of New York City. Traveling is simple and convenient with two easily accessible train stations within New Providence and our proximity to I-78, the Garden State Parkway, New Jersey Turnpike and Newark Liberty International Airport.

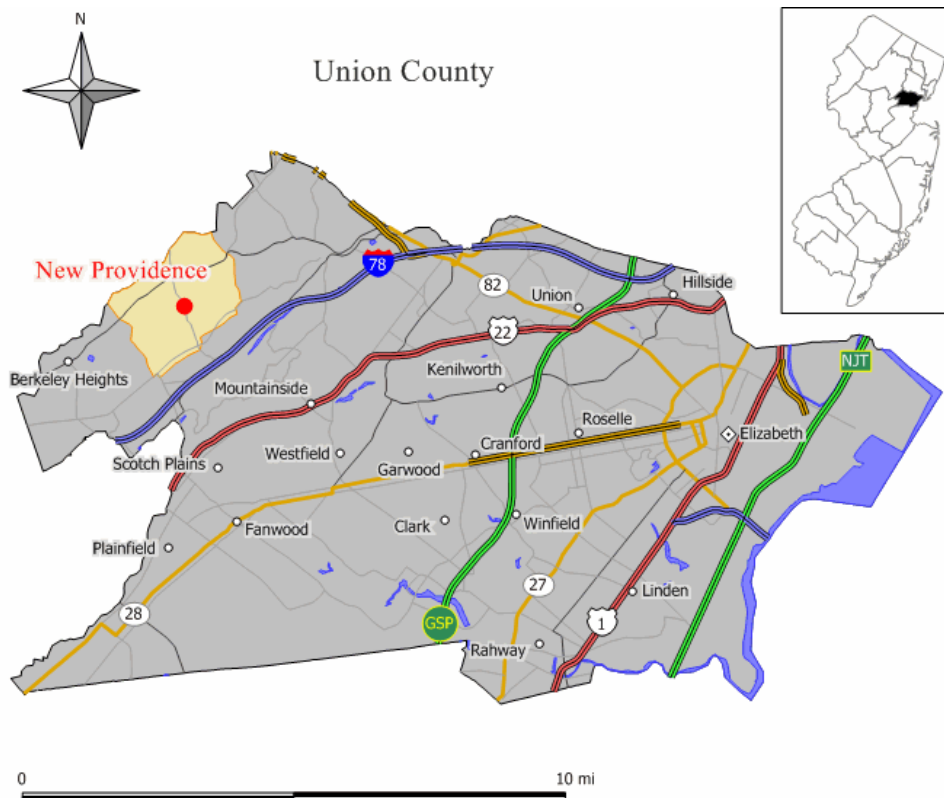

History of New Providence

New Providence lies on the slope between the heights of Stony Hill at Mountain Avenue and the meandering Passaic River below. Indians of the Lenni Lenape tribe were the first known inhabitants of this region. The history of New Providence can be first traced back to 1664 when James, Duke of York and brother to King Charles II, purchased the land from these Native Americans. The territory purchased was quite large and included the land where New Providence, Berkeley Heights and Summit, as well as several other communities, are now located.

The first settlers were a Puritan colony that came to the area in 1720. The abundance of large flocks of wild turkeys led to the initial name for the area of Turkey. From 1736 – 1738 many families were buying land near the Passaic River. Before long, these settlers had established homes and built a Presbyterian Church, which became the center of life in the small settlement. Local history is interwoven with the Presbyterian Church because of an accident that took place there in 1778. A partially completed gallery gave way during a meeting and fell on the people seated below. No one was seriously injured, and the survivors attributed this to Divine Providence. In gratitude, the residents changed the name of the settlement from Turkey to New Providence, which included present-day Summit and Berkeley Heights.



New Providence contributed men to the Revolutionary cause, but its soil remained unscathed by battle. Forty-eight men who served in Washington's army are buried in the Presbyterian Cemetery.



In 1869 Summit seceded from New Providence Township over disagreement with town management, as well as its rapid increase in population and businesses due to its railroad facilities. New Providence Borough was formed in 1899 and present-day Berkeley Heights retained the name New Providence Township until 1952.

Government

Local Government

New Providence has been governed by a mayor and council since it was incorporated as an independent, self-governing municipality on March 14, 1899. To strengthen the executive arm of borough government, the position of borough administrator was created by local ordinance in 1962.

The local government provides services for the residents, and in turn collects taxes which pay for those services. Portions of the tax also go to the county and public schools. The schools are administered independently of the borough government by an elected board of education.

The municipal services include planning and zoning, police protection, public health and welfare, road maintenance, garbage and recycling collection, sewage and storm drainage systems, the public library, and recreational parks and facilities.



Volunteer groups who operate under governmental direction give fire protection, ambulance service, and disaster relief. Private utilities are responsible for furnishing gas, water, electricity, and transportation.

The Municipal Center, located at 360 Elkwood Avenue, houses the borough administrative offices, including the Borough Administrator, Borough Clerk, Tax Collector, Tax Assessor, Engineering Department, and Building Department, as well as the Borough Nurse, Recreation Department, Municipal Court, and Police Department. The Board of Education is also located within the building.



Additional information regarding Department of Public Works (DPW) services and recycling can be found on the borough website at www.newprov.us

Federal, State, and County Representation

New Providence is in the Seventh Congressional District and is part of New Jersey's 21st Legislative District.

New Jersey's Seventh Congressional District covers portions of Hunterdon County, Middlesex County, Somerset County and Union County. Information regarding the current Seventh Congressional District representatives can be found at www.congress.gov. New Jersey's 21st Legislative District covers portions of Morris, Somerset, and Union Counties. Information regarding representation in the 21st Legislative District can be found at www.senate.gov.

Information about the current Governor of New Jersey can be found at www.nj.gov.

Union County is governed by the nine-member Union County Board of County Commissioners, elected at-large to three-year terms on a staggered basis. The county government is responsible for the construction and maintenance of county roads and bridges and the operation of a county jail. It may operate many programs, such as police and fire training academies and emergency services, maintain park and recreation systems, administer programs for special groups, and usually assumes public health functions. Information about the Union County Board of County Commissioners can be found at <https://ucnj.org/commissioners/>.



Demographics

As of the 2020 United States Census, there were 13,650 people and 5,497 housing units in New Providence. There were 4,944 households, of which 38.1% had children under the age of 18 living with them, 66.7% were married couples living together, 7.7% had a male householder with no spouse/partner present, 23.4% had a female householder with no spouse/partner present, and 15.2% had someone living alone who was 65 years of age or older. The average household size was 2.71 and the average family size was 3.26.

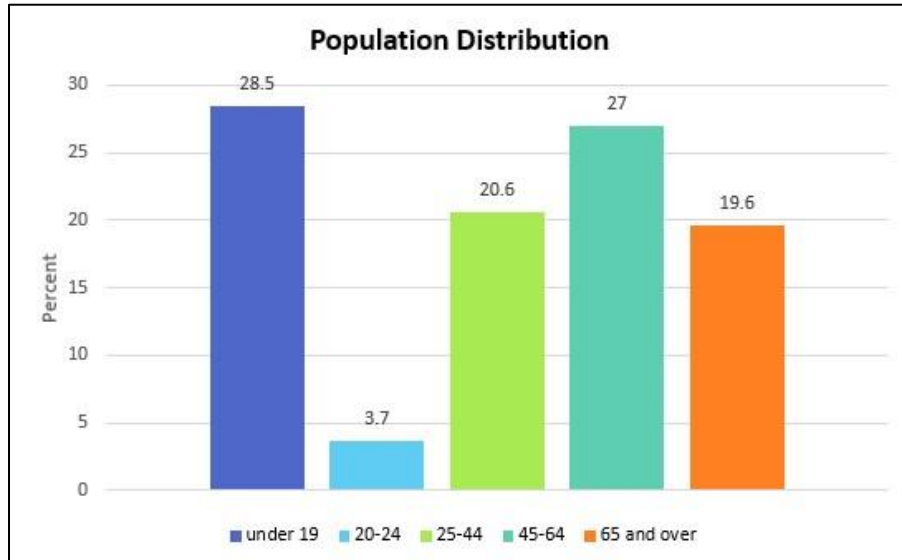

In New Providence the population was spread out with 28.5% under the age of 19, 3.7% from 20 to 24, 20.6% from 25 to 44, 27.0% from 45 to 64, and 19.6% who were 65 years of age or older. The median age was 43.3 years.

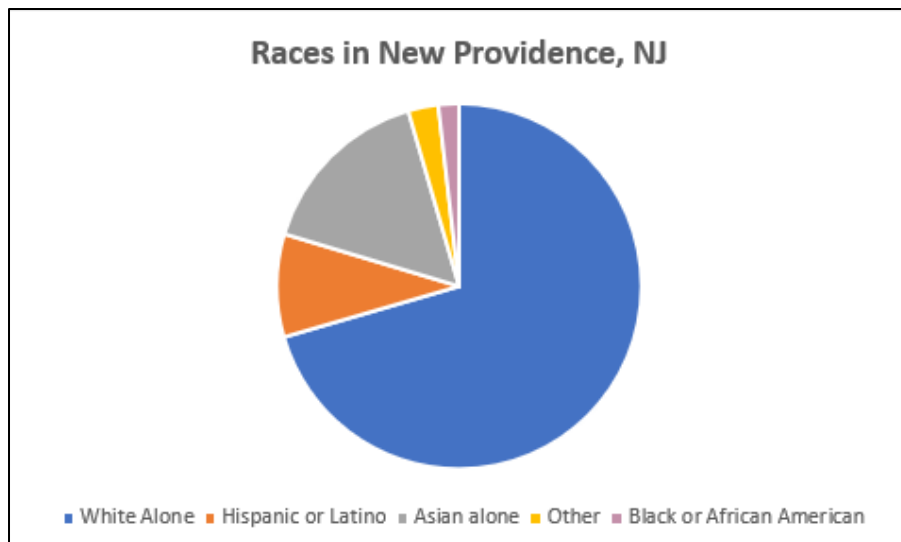

[Sources: 2020 U.S. Census Bureau S0601](#)

[US Census QuickFacts](#)

2020 CENSUS DATA

Most New Providence residents hold professional, managerial, or other executive positions in their business or industry with an above average salary. Among the most common occupations in New Providence are:

Management, business, science, and art, 65.2%

Sales and office occupations, 17.5%

Service occupations, 7.9%

Approximately 79.3% of workers in New Providence work for companies, 16.0% work for the government and 4.2% are self-employed (own not incorporated business).

According to the 2020 Census, the median income for a household in the borough was \$162,877, the, the median income for a family was \$191,154, and per-capita income was \$86,023. About 2.1% of the population was below the poverty line, including 1.1% of those under age 18 and 3.3% of those age 65 or over.

MEDIAN HOUSEHOLD INCOME BY AGE

Median household income	\$162,877
Householder 25-44	\$147,763
Householder 45-64	\$238,340
Householder 65 and older	\$108,317

[Sources: 2020 U.S. Census Bureau, DP03, S1903](#)



Residential & Business Communities

Residential Community

New Providence is mostly a residential community consisting of owner occupied, single-family dwellings, with garden apartments, condominiums, and a vibrant senior living community.



NEW PROVIDENCE - 2020 U.S. CENSUS DATA

HOUSING UNITS

Total housing units	5,497
Renter-occupied housing units	24.4%
Average number of renter household members	2.05
Median rent	\$1,906
Owner-occupied housing units	75.6%
Average number of owner household members	2.75
Median owner value	\$734,300

[Sources: 2020 U.S. Census Bureau, DP03](#)

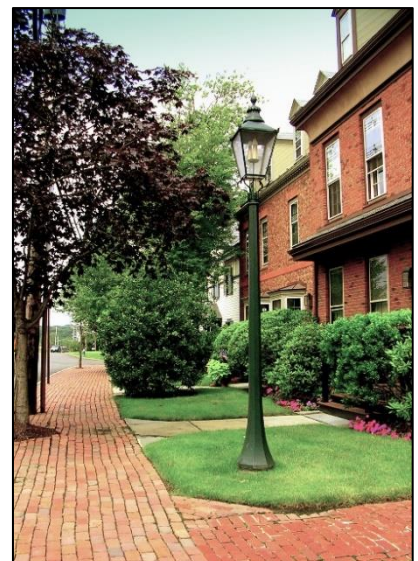

Business Community

New Providence is a warm and welcoming community where you'll find friendly store owners and nice neighbors. We boast a vibrant downtown business district with ample free parking. We are very proud of our fine specialty shops, unparalleled service providers, and incredible restaurants. Visit the New Providence Business Community website at www.newprovidencebiz.com.



In addition to our local businesses and professionals, corporate businesses include companies with worldwide reputations in their field. New Providence hosts corporate and executive offices that include Summit Health, the NJ Sharing Network, and Nokia Bell Labs.

The New Providence Business Community has proudly sponsored popular community events like the Summer Concert Series, Downtown Trick or Treating, the Annual Street Fair, and the Holiday Walk.

Learn more about New Providence Business at www.newprovidencebiz.com.



Community Activities & Recreation

The New Providence Community Activities Department provides a wide variety of programs for children, adults, and seniors.



Facilities:

- Recreation Center with art room, gym, and yoga room
- Nine parks with fields, walking paths and picnic areas
- Five playgrounds
- Twelve multi-sport fields
- Eight public tennis courts
- Two pickleball courts
- A cricket pitch
- Five basketball courts
- A community garden

Visit www.newprov.us for more information.

Recreational offerings:

- Year-round classes, sports, leagues, and programs for adults and children
- Youth Summer camps and classes
www.newprov.us/recreation
- New Providence Community Pool
www.nppool.org



DeCorso Senior Center:

Senior-focused activities and programs each week:

- Exercise classes
- Bingo and Senior Club meetings
- Guest speakers
- Group activities such as bridge, mahjong, knitting, and book club

For information, call the DeCorso Center at (908) 665-0046



Community Activities:

New Providence hosts town-wide activities, including:

- Fishing Derby
- Memorial Day parade
- Sustainability activities: shredding day, freecycle, park cleanup day
- July 3 Fireworks
- National Night Out



Education

New Providence enjoys a long tradition of educational excellence, with an ongoing commitment to academics, the arts, athletics, community service, and character education. The school district has earned recognition at the national, state, county, and local levels for the achievements of students and staff. Student assessment scores remain among the highest in the area.

In partnership with students, teachers, parents and community, the mission of the New Providence School District is to prepare our students academically for their pursuits, to develop the appropriate social and emotional skills to be productive, empathetic, global citizens, and to stimulate a growth mindset for continued, life-long learning in a culturally diverse society.



Offering a comprehensive Pre-K to Grade 12 educational program, the district serves a high school, middle school, and two elementary schools. Programs of study are carefully aligned to the New Jersey Student Learning Standards, with a strong emphasis on technology integration. Co-curricular activities offer all students many opportunities to meet their needs and interests. Participation in a well-rounded curriculum is encouraged.

Our schools are staffed with dedicated and highly qualified professionals who work closely with parents to ensure safe and caring environments. Our ongoing, district-wide character education program continues to focus on developing responsible, respectful, caring, and informed citizens who are equipped to become the 21st century leaders.

Supportive services are available through the Department of Educational Services and the Department of Special Services. These services include the Gifted and Talented, Basic Skills, and English as a Second Language programs, as well as reading specialists, speech/language specialists, occupational and physical therapists, guidance personnel, special education instructors, and a child study team.

There are two public K-6 schools, as well as one parochial elementary school. The middle school is adjacent to the high school and consists of grades 7-8. New Providence High School is consistently highly ranked by national surveys such as U.S. News & World Report.

Schools in the district are:

- Allen W. Roberts Elementary School (grades PK-6)
- Salt Brook School (K-6)
- New Providence Middle School (7&8) / New Providence High School (9-12): both schools share the same building and some of the same facilities (art rooms, auditorium, east wing, west wing, gyms, music rooms, TV production room, cafeteria).

New Providence also is home to a private school, Our Lady of Peace Catholic School.

New Providence is a well-educated community. For population 25 years and over:

High school or higher:	95.8%
Bachelor's degree or higher:	66.6%
Graduate or professional degree:	32.6%

[Source: 2020 U.S. Census Bureau, American Community Survey, S1501](#)

New Providence is also within close proximity to several area institutes of higher learning. Colleges/universities with over 2,000 students nearest to New Providence are:

- Drew University (about 5 miles; Madison, NJ)
- Union County College (about 8 miles; Cranford, NJ)
- Kean University (about 10 miles; Union, NJ)
- Seton Hall University (about 10 miles; South Orange, NJ)
- Rutgers University-New Brunswick (about 15 miles; New Brunswick, NJ)
- University Of Medicine and Dentistry Of New Jersey (about 16 miles; Newark, NJ)
- County College of Morris (about 16 miles; Randolph, NJ)



New Providence Memorial Library

The New Providence Memorial Library was opened in 1921 and has greatly expanded over the years. The Memorial Library is home to over 70,000 volumes of books and reference materials, in addition to over 120 different periodicals, which it lends free of charge to any resident in town.

Founded by a citizens group in 1921, the library at first was supported by funds raised at card parties, food sales, movie benefits and dramatic productions. When it first opened, the library owned 15 books and borrowed 50 more. In 1942 the library became a municipal service maintained by funds appropriated by the Borough Council and supervised by a board of trustees appointed by the mayor with the approval of the council.



The oldest part of the present library building was completed in 1950 with the help of funds given by the townspeople as a memorial to the men of New Providence who died in World War II. A wing was added in 1958 and in 1966 two large additions quadrupled the space. The library underwent extensive renovations in 2005 and now offers comfortable reading and meeting rooms, wireless internet access, state-of-the-art reference tools, a children's library, art displays, reading groups, and a host of online resources. The library is located at 377 Elkwood Avenue, adjacent to the Municipal Center.



Transportation

Service on the New Jersey Transit Gladstone Branch of the Morris & Essex Lines is available at the New Providence and Murray Hill stations, offering service to Hoboken Terminal and to Penn Station in Midtown Manhattan. Transportation to New York City in less than one hour is easily accessible with scheduled buses and two train stations to downtown and mid-town New York. Two Gladstone Branch trains each weekday morning offer one-seat rides to Manhattan, and two evening trains leave New York and stop at both of New Providence's stations on the way to Gladstone. All other rail service is to or from Hoboken. These trains connect at Summit or Newark Broad Street with Manhattan-bound trains.

Lakeland Bus Lines offers weekday rush hour service from stops along Springfield Avenue to New York's Port Authority Bus Terminal.

Newark Liberty International Airport is approximately sixteen miles east of New Providence.



2020 CENSUS DATA

TRANSPORTATION TO WORK

	Number
Workers 16 and over	6,098
	Number
Public transportation	723
Car, truck, van	3,398
Walk	71
Work at home	1,664
Mean travel time to work (minutes)	34.2

[Sources: 2020 U.S. Census Bureau, DP03](#)

Directory of Borough Services

Emergencies 9-1-1

A

Accident Reports (Police)	908-665-1111
Administrator/CFO	908-665-1400
Allen W. Roberts Elementary School	908-464-4707
Animal Control (St. Hubert's Giralda, Madison)	973-377-2295
Animals, Missing (Police)	908-665-1111
Assessor, Tax	908-665-8271
Assessor's Clerk, Tax	908-665-7956
Assistant Tax Collector	908-665-0631

B

Bicycle Licenses (Clerk)	908-665-1400
Bicycles, Missing (Police)	908-665-1111
Birth Certificates (Clerk)	908-665-1400
Block Party (Police)	908-665-1111
Board of Adjustment	908-665-1129
Board of Education	908-464-9050
Board of Health	908-665-1400
Borough Administrator	908-665-1400
Borough Clerk	908-665-1400
Borough Clerk, Deputy	908-665-2167
Borough Engineer	908-665-8250
Building Permits (Building)	908-665-1098

C

Cat License (Clerk)	908-665-1400
Chief Financial Officer	908-665-1400
Civil Union Licenses (Clerk)	908-665-1400
Collector, Tax	908-665-8031
Community Pool	908-464-4141
Construction Official	908-665-1098
Consumer Affairs Office, Union County	908-654-9840
Court Administrator	908-665-1454
Crossing Guards, School (Police)	908-665-1111

D

Death Certificates (Clerk)	908-665-1400
Deer - Dead (Police)	908-665-1111
Department of Public Works	908-665-1076
Deputy Borough Clerk	908-665-2167
Disabled Veterans, Tax Exemptions (Collection)	908-665-8031
Dog License (Clerk)	908-665-1400
Domestic Partner Registration (Clerk)	908-665-1400
Dumping, Illegal (Union County Hotline)	908-388-3222

E

Education, Board of	908-464-9050
Election Information (Clerk)	908-665-1400
Elections, Union County Board of	908-527-4127
Electrical Permits (Building)	908-665-1098
Electricity (Jersey Central Power & Light Co.)	800-662-3115
Emergency Management (Police)	908-665-1111
EMS (non-emergency)	908-464-8216
Engineer, Borough	908-665-8250
Environmental Health Commission, Union County	908-382-5585

F

Fingerprinting (Police)	908-665-1111
Fire Alarm Permits	908-665-1098
Fire Chief	908-665-1400
Fire Department (Emergency)	9-1-1
Fire Department (non-emergency)	908-665-1081
Fire Inspector	908-665-1098
Fire Official	908-665-1098
Firearms Permits (Police)	908-665-1111
Fishing & Hunting Licenses (Clerk)	908-665-1400

G

Garbage Hotline	973-227-7020
Gas (Public Service Electric and Gas Co.)	800-436-7734

H

Health, Board of	908-665-1400
House Checks, Vacation (Police)	908-665-1111
Hunting & Fishing Licenses (Clerk)	908-665-1400

I

Income Tax Info, Federal (8:15 a.m.-4:15 p.m.)	800-829-1040
Income Tax Information, State	800-323-4400

J

Judge, Municipal	908-665-1454
-------------------------	---------------------

L

Lakeland Bus Lines (To Port Authority, NYC)	973-366-0600
Leaf Collection Site (DPW)	908-665-1076
Library Director	908-665-0311
Licenses- Bicycle	908-665-1400
Licenses- Cat	908-665-1400
Licenses- Dog	908-665-1400
Licenses- Marriage	908-665-1400
Licenses- Raffle	908-665-1400
Low-income Housing	908-665-8254

M

Marriage Licenses / Civil Union (Clerk)	908-665-1400
Middle School, New Providence	908-464-9161
Motor Vehicle Fines (Municipal Court)	908-665-1454
Municipal Alliance (Clerk)	908-665-1400
Municipal Center	908-665-1400
Municipal Court	908-665-1454
Municipal Judge	908-665-1454

N

New Providence Historical Society	908-665-0311
NJ DMV (24 hour info.)	609-292-6500
NJ DOT (animal removal, flooding, potholes, snow removal, ice control - state highways)	973-648-2550
NJ Transit - Bus and train info	800-772-2222
NJ Transit - Customer Service	800-772-3606

O

Ordinances, Borough Council	908-665-1400
------------------------------------	---------------------

P

Parking Permit (Clerk)	908-665-1400
Passport Information: Elizabeth	908-527-4966
Passport Information: Westfield	908-654-9859
Payroll/Personnel	908-665-0448
Peddlers' Permit (Clerk)	908-665-1400
Permits - Peddler (Clerk)	908-665-1400
Permits- Building and Construction	908-665-1098
Permits- Burglar Alarm (Police)	908-665-1111
Permits- Fire Alarm (Building)	908-665-1098
Permits- Tree Removal (Clerk)	908-665-1400
Planning Board	908-665-0457
Poison Control Center, State	800-764-7661
Police (emergency)	9-1-1
Police (non-emergency)	908-665-1111
Police Auxiliary	908-665-1111
Pool Construction Permits	908-665-1098
Pool, Community (seasonal)	908-464-4141
Post Office	908-665-0900
Potholes (DPW)	908-665-1076
Prosecutor, Municipal (Court)	908-665-1454
Public Defender (assigned by Judge)	908-322-8211
Public Health Nurse	908-464-7308
Public Information Officer	908-665-1400
Public Library	908-665-0311
Public Works Manager	908-665-1076

R

Raffle License (Clerk)	908-665-1400
Recreation Department and Commission	908-464-4430
Recreation Director	908-665-8258
Recycling Coordinator	908-665-1076
Recycling Hotline	888-738-7348
Rescue Squad (non-emergency)	908-464-8216
Road Maintenance (DPW)	908-665-1076

S

Saint Hubert's Giralda (animal control)	973-377-2295
School Crossing Guards (Police)	908-665-1111
Senior Citizen Director	908-665-0046
Sewage Backup in streets and roads (DPW)	908-665-1076
Snow Removal (DPW)	908-665-1076
Social Security Administration, U.S.	800-772-1213
Superintendent of Schools	908-464-9050
Swimming Pool, Community	908-464-4141
Swimming Pool, Licenses (Building)	908-665-1098

T

Tax Appeals (Union County Board of Taxation)	908-527-4775
Tax Assessor	908-665-8271
Tax Assessor's Clerk	908-665-7956
Tax Collector	908-665-8031
Tax Collector, Assistant	908-665-0631
Tree Removal Permits (Clerk)	908-665-1400

U

Union County Customer Info. Line	908-518-9000
Union County DPW	908-789-3660
Union County Regional Environmental Health Comm. (air and noise pollution) - 24 hr.	908-388-3222

V

Vacation House Checks (Police)	908-665-1111
Variances (Board of Adjustment)	908-665-1124
Veteran's Tax Deductions (Tax Collection)	908-665-8031
Voter Registration (Clerk)	908-665-1400

W

Wastewater Treatment Plant	908-665-1077
Water (New Jersey-American Water Co.)	800-987-5325

Z

Zoning Information (Building)	908-665-1098
--------------------------------------	---------------------

Helpful Information

UTILITY COMPANIES

Electric

Jersey Central Power and Light Co.
800-452-9155
www.firstenergycorp.com

Gas

PSEG
800-662-3115
www.pseg.com

Cable

Comcast of New Jersey
800-266-2278
www.comcast.com

Verizon

800-VERIZON (1 800-837-4966)
Monday - Friday 8:00am - 6:00pm EST
www.verizon.com

Water

NJ American Water Company
800-652-6987
<https://www.amwater.com/njaw/>

AUTOMOBILE REGISTRATION

New Jersey Motor Vehicle Commission
888-486-3339
www.state.nj.us/mvc

VOTER REGISTRATION

<http://www.ucnj.org/ctyclerk/election.html>

New Jersey Citizens Guide to Government
<http://www.lwvnj.org/pubs/CG08.pdf>

SCHOOLS

New Providence School District
365 Elkwood Avenue
New Providence, NJ
908-464-9050
<http://www.npsd.k12.nj.us>

LIBRARY

New Providence Memorial Library
377 Elkwood Avenue
New Providence, NJ
908-665-0311
<http://www.newprovidencelibrary.org>

SENIOR CENTER

15 East Fourth Street
New Providence, NJ 07974
Phone: 908-665-0046
Fax: 908-665-6421
<https://www.newprov.us/278/Seniors>

FIRE DEPARTMENT

175 Floral Avenue
New Providence, NJ 07974
Phone: 908-665-1400
<https://newprovidencefire.org/>

RESCUE SQUAD

7 Academy Street
New Providence, NJ 07974
908-665-8216 (non-emergency)
<https://newprovidenceems.org/>

TAX INFORMATION

Federal

Internal Revenue Service

800-829-1040

Forms

800-829-3676

www.irs.gov

State

NJ Division of Taxation

609-292-6400

www.state.nj.us/treasury/taxation

Refund Inquiry

800-323-4400

HOSPITALS

Morristown Memorial Hospital

100 Madison Ave., Morristown

973-971-5000

www.morristownmemorialhospital.org

Newark Beth Israel Medical Center

201 Lyons Ave., Newark

973-926-7000

www.saintbarnabas.com/hospitals/newark_beth_israel

Overlook Hospital

99 Beauvoir Ave., Summit

908-522-2000

www.overlookhospital.org

Cooperman Barnabas Medical Center

Old Short Hills Road, Livingston

973-322-5000

<https://www.rwjbh.org/cooperman-barnabas-medical-center/>

PUBLIC TRANSPORTATION

Railroad

NJ Transit

800-772-2222

www.njtransit.com

Murray Hill Train Station Permit Parking

Foley Pl. between Floral Ave. & Southgate Rd. (Across from Murray Hill Square)

Murray Hill Train Station Non-permit Parking

Floral Avenue between South Street and RR Crossing

New Providence Train Station Permit Parking

Springfield Avenue & Pittsford Way (Station is located at 803 Old Springfield Ave. accessible via underpass)

PATH

800-234-7284

www.panynj.gov/CommutingTravel/path/html

Bus

DeCamp Bus Lines

973-783-7500

www.decamp.com

Lakeland Bus Lines

973-366-0600

www.lakelandbus.com/Sched2478E.html

NJ Transit

800-772-2222

www.njtransit.com

Ferry

Hoboken or Jersey City (to World Financial Center)

800-533-3779

www.nyc.gov/html/dot/html/masstran/ferries/ferintro.html

NEW PROVIDENCE HOUSES OF WORSHIP

Faith Lutheran Church
524 South Street
908-464-5177
www.famfaith.org

Our Lady of Peace Church
111 South Street
908-464-7600
www.ourladyofpeaceparish.org/

Presbyterian Church at New Providence
1307 Springfield Avenue
908-665-0050
www.pcnp.org

St. Andrew's Episcopal Church
419 South Street
908-464-4875
www.standrewschurch.org

St. Luke's Reformed Episcopal Church
260 South Street
908-464-1945
www.stlukesrecnj.org

United Methodist Church of New Providence
1441 Springfield Avenue
908-464-5535
www.gbgm-umc.org/npumenj

Borough Map and Street Directory

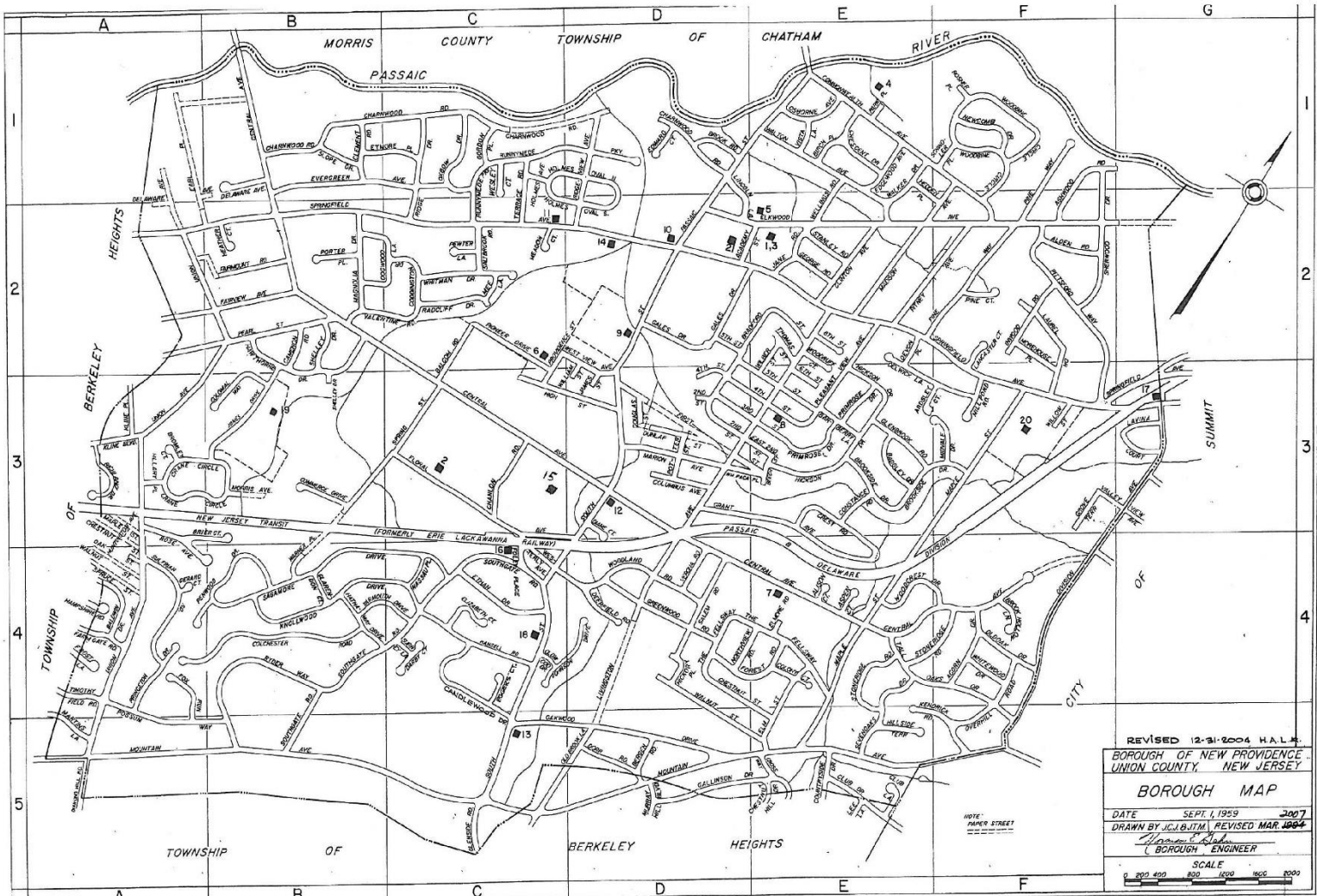

Please see next page for street directory

NEW PROVIDENCE STREET DIRECTORY AND MAP

Academy Street	D 2	E 2	Cross Way	E 5	Gordon Place	C 1	Mildvale Drive	E 3	Sagamore Drive	B 4	C 4	William Street	D 2	D 3
Acom Drive	F 4		Grant Avenue		Millpond Road	D 3	Millpond Road	F 3	Salem Road	D 4		Willow Street	F 3	
Alden Road	F 2		Darby Court	C 4	Greenwood Road	D 4	Morehouse Place	F 2	Salt Brook Road	C 2		Woodbine Circle	F 1	
Alison Court	E 4		Deerfield Road	C 4	Grove Terrace	F 3	Morris Avenue	B 3	Schindler Place	F 1		Woodcrest Drive	E 4	F 4
Ardsley Court	E 3	F 3	Delaware Avenue	A 2	Hampshire Road	A 4	Mountain Avenue	A 5	Second Street	D 3	E 3	Woodland Road	C 4	D 4
Ashwood Road	F 1	F 2	Delwick Lane	E 2	Hansell Road	C 4			Severnoaks Drive	E 4	E 5	Woodruff Court	E 2	E 3
Aspen Court	E 4		Devon Place	E 2	Hathaway Drive	B 2	Nassau Place	C 4	Shelley Drive	B 2				
			Diamond Hill Road	A 5	Hawthorne Drive	B 2	Newcomb Drive	F 1	Sherwood Drive	F 1	F 2	Yarmouth	B 4	C 4
Badgley Drive	E 3		Diane Court	D 3	Heather Court	B 2	Northview Road	D 4	Sixth Street	E 3				
Balcom Road	C 2	C 3	Division Avenue	F 4	Hedden Place	E 1	Oak Street	A 4	Slope Drive	B 1		Points of Interest:		
Baldwin Drive	A 4		Dogwood Lane	B 2	Hickory Place	D 4	Oakwood Drive	C 5	South Street	D 2	C 5	Police Station	D 2	C 5
Barberry Lane	E 3		Dorr Road	D 5	Hickory Drive	E 3	Old Brook Lane	D 5	Southgate Road	B 4	C 4	Fire Headquarters	B 3	C 3
Beech Street	E 3		Douglas Street	D 3	High Street	C 3	Old Oak Drive	F 4	Spring Street	A 2	G 3	Municipal Center	A 2	G 3
Bergen Road	D 5		Dunlap Street	D 3	Hillside Place	A 3	Oldwood Drive	C 4	Springfield Avenue	A 4		Boro Garage/Wastewater Treatment Plant	A 4	
Birch Place	E 1				Hillside Terrace	E 5	Osborne Avenue	E 1	Spruce Street	E 2		New Providence Library	E 2	
Bradford Street	D 3	E 2	Earl Place	A 1	Hillside Terrace	C 1	Overhill Road	F 4	Stanley Road	E 4	E 5	High School	E 4	
Brier Court	A 3	B 3	Edgewood Avenue	E 1	Holmes Avenue	C 1	Ox Bow Drive	F 5	Stoneridge Road	E 4		Morris-Union Jointure Commission School	E 4	
Bromley Court	A 3		Edward Court	D 1	Holmes Oval North	C 1			Suffrian Road	A 4		Senior Citizen Center	C 4	
Brook Hollow Lane	F 4		Eggers Court	C 4	Holmes Oval South	D 1	Park Place	E 1	Surrey Lane	E 4	F 5	Our Lady of Peace Church & School	E 4	
Brook Road	D 1		Elizabeth Court	E 2	Huntington Avenue	A 3	Passaic Street	D 2	Tail Oaks Drive	E 1		Presbyterian Church	E 4	
Brookside Drive	E 3	F 3	Elkwood Avenue	C 4			Pearl Street	E 1	Terrance Road	A 2	B 2	Methodist Church	C 1	C 2
			Elm Street	D 2	Inwood Road	F 2	Pemwood Drive	A 4	The Felsway	A 4	B 4	St. Lukes Reformed Episcopal Church	D 4	E 4
Cameron Road	B 2		Elmore Road	E 4	James Street	D 3	Pewter Lane	C 2	Third Street	F 2		Faith Lutheran Church	D 3	E 3
Candlewood Drive	C 4	C 5	Ethan Drive	C 4	Jane Road	E 2	Pine Court	F 2	Thomas Street	E 2	F 1	Historical Society - Salt Box Museum	E 2	
Central Avenue	B 1	F 4	Etmore Place	B 1	Johnson Drive	C 4	Pine Way	E 2	Timothy Field Road	A 4		New Providence Post Office	A 4	
Charlton Road	C 3		Evergreen Avenue	B 1	Jones Drive	B 2	Pioneer Drive	C 2	Union Avenue	E 2	F 1	Murray Hill RR Station	A 1	A 5
Charmwood Road	B 1	D 1		C 1			Pitney Avenue	E 2		F 2	F 3	New Providence RR Station	B 2	C 2
Chestnut Hill Drive	E 5		Fairmont Road	A 2	Kendrick Road	E 5	Pittsford Way	F 2	Valentine Road	B 2	C 2	St. Andrews Episcopal Church	F 3	G 3
Chestnut Street	D 4	E 5	Fairview Avenue	B 2	Kline Boulevard	A 3	Pleasantview Avenue	E 2	Valley View Avenue	D 4		Allen W. Roberts School	D 4	
Clarendon Court	B 4		Farm Gate Road	A 4	Kline Place	A 3	Porter Place	B 2	Verona Road	E 1		Rescue Squad Headquarters	E 1	
Clement Road	E 2		Fifth Street	D 2	Krohnwood Drive	B 4	Possum Way	A 4	Vista Lane	B 4	B 5			
Clinton Ave	E 2		First Street	D 3	Lancaster Court	F 2	Primrose Drive	E 3	Walker Drive	E 1	E 2			
Club Drive	E 5		Floral Avenue	B 3	Laurel Drive	F 2	Princeton Drive	A 4	Walnut Street	D 4	E 5			
Coddington Drive	C 2		Foley Place	C 4	Lavina Court	G 3	Providence Street	C 2	Walton Avenue	B 3	B 4			
Colchester Road	A 4	B 4	Forest Road	D 4	Lee Lane	E 5			Warner Place	E 1	E 2			
Colonial Way	B 3		Fourth Street	D 3	Livingston Avenue	D 5	E 2		Wellings Road	B 3	B 4			
Colony Court	E 4		Fox Run	A 4					Wesley Court	C 1				
Columbus Avenue	D 3		Frost Lane	A 4					Wesley Court	C 1				
Commerce Drive	B 3				Madison Avenue	E 2	Richland Drive	A 3	Wesley Court	C 1				
Commonwealth Avenue	E 1	F 2	Gales Drive	D 2	Magnolia Drive	B 2	Ridge Drive	C 2	Westerly Avenue	C 4				
Constance Road	E 3		Gallison Drive	D 5	Maple Street	E 5	Ridgeview Avenue	D 1	Westview Avenue	C 2	C 3			
Countingside Drive	E 5		George Road	E 2	Marion Avenue	F 3	Rose Avenue	A 3	Whitman Drive	F 4				
Crane Circle	A 3	B 3	Gerard Court	A 4	Martins Lane	D 3	Runnymede Parkway	F 1	Whitman Drive	C 2				
Crescent Drive	E 1		Glenbrook Road	E 3	Meadow Court	A 4	Ryder Way	C 2	Wilber Street	E 2	E 3			
Crest Road	E 3	E 4	Glenzie Road	C 5	Mee Lane	C 2		B 4	William Paca Place	D 3	E 3			